**Disclaimer:**

We will not be responsible for any consequence caused by any alteration of wiring, structure and function without our authorization. Hereby declare!

- This manual is only suitable for sale and use in the Chinese market.
- The illustrations used in this manual are to illustrate the operation method and product structure of the product. If there is a small difference between the actual product and the illustrations, please refer to the actual product.
- In order to improve the quality of the product, we may change part of the structure and appearance of the product without notice. Please forgive me.
- The package contains important information which must be retained.

Model: HZB -200**Electric stroller**

Please read this manual carefully before use

The manual contains important information. Please keep it for future reference



Cool music, USB interface



Contents

1. Parameter specification
2. Decomposition diagram
3. Assembly steps
4. Instructions for use
5. Charging
6. Troubleshooting
7. Maintenance and care
8. Product circuit dia-

1. Parameter specification

Applicable age	3-6 Yrs	Charging time	8-12 hours
Load limit	30KG	Overall dimension	150*70*70cm
Speed	5-7 km/h	Battery	12V 7AH
Motor specifications	Motor RS550-12V 10000RPM		
Charger	Input AC220V, output DC12V1000MA		

Repair and maintenance

Before use, parents should check whether the main parts are in good condition, and whether the battery, charger, wire, plug, housing and other parts are damaged. Whether the screw is loose; If there is a potential safety hazard, stop using it when found damaged until it is fully repaired.

After a period of use, lubricate the iron parts of the following vehicles with a small amount of lubricating oil to prevent wear and rust. Vehicles should be kept away from the source of fire and avoid prolonged exposure to light. Storage should be flat, not upside down, tilt; In wet weather, vehicles should be parked indoors or covered with a tarp.

Vehicles should be kept away from hot objects, such as live roads, beside heaters, and plastic parts may melt. When charging, keep away from inflammables and prevent fire.

Please charge in time after use, charge must be adult operation. If it is stored or not used for a long time, it must be fully charged and then recharged at least once a month to extend the battery's life.

When cleaning the vehicle, use a dry soft cloth to wipe the vehicle, or use a non-wax furniture polishing department to replace the soft cloth to wipe the material parts, so as to achieve the surface finish effect. Do not use the chemical melting machine to wipe the plastic parts of the toy. Do not wash the vehicle with soap and water. Do not accelerate the vehicle in rainy or snowy weather.

When you stop using or preventing the product, please cut off the power of the product and turn all the switches to the "stop" or "off" position to prevent the vehicle from being powered on.

Do not use protectors that do not conform to this product. Please do not change the structure and wiring system of the product without authorization. Maintenance work must be carried out under the guidance of professional or technical personnel.

Fault type	Check parts	Method of exclusion
Motor does not turn	1. Is the vehicle protector loose? (in the black protector box under the seat: page 4) 2. Is the foot switch line in good condition? 3. Is the welding line on the motor terminal in good condition? 4. Is the motor lead plugged into the controller? 5. Disconnect the motor plug and connect it directly to the battery. Is it rotating?	Yes, replace with a new protector No, next. No, plug the cable in; yes, next. No, solder the terminal wire; yes, next. No, plug in the lead; yes, next. No, change the motor; yes, check the forward / backward switch and controller link line, or contact the agent and dealer.
Go forward without going backward, or go backward without going forward	1. Is the forward/backward switch wired incorrectly? 2. Is the remote control of the controller not working?	Yes, change the correct wiring method; No, next. No, check the forward / backward switch again; Yes, contact an agent or dealer.
Not charging	1. Is the battery plug-in loose? 2. Does the charger feel slightly hot when charging?	Yes, lock the battery plug-in; no, next. No, maybe the charger is broken. Replace the charger.
Very slow	1. Check whether the battery voltage is over 10V? 2. Connect the motor (with gear box) directly to the battery, will the speed be increased?	No, charge; yes, next. No, next item; drive circuit board fault, contact dealer or dealer.
The car can move without sound and lights	1. Check whether the sound control and light switch are in good condition? 2. Check whether the wires from the battery to the switch are plugged in?	No, switch; yes, next. No, connect the plug-in and connect the disconnection.
The swing motor does not turn	1. Check whether the swing motion switch is in good condition? 2. Is the connector terminal in good condition? (with drive motor)	No, the swing motion switch is a double row plug, the line can be replaced on one side; yes, next item. No, plug it in again; yes, next. No, contact an agent or dealer;
Sometimes the car goes and sometimes stops	1. Are you driving over rough ground? 2. Check if the flat wheel can rotate freely?	1. Yes, under normal conditions, the product should be driven on a flat road; 2. Remove the wheel and wheel uranium fault.
For the above troubleshooting methods, please contact the agent or dealer when the user's conditions are not available.		

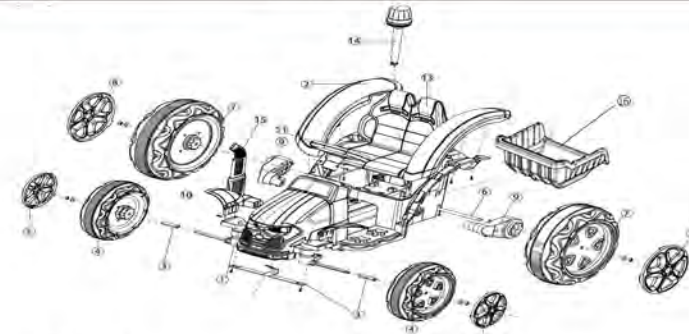

Parts drawing

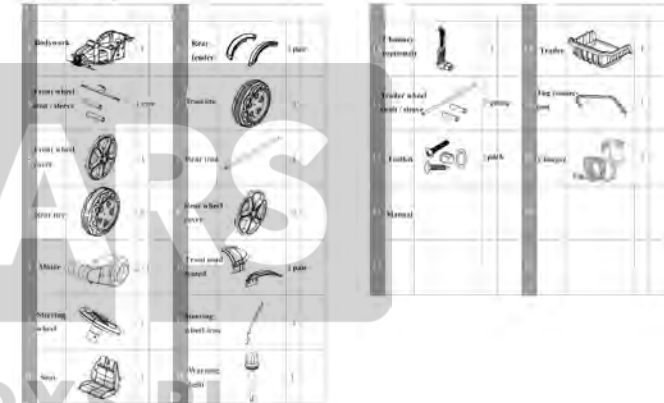
**Front wheel iron installation**

1. Find the fixing parts of the steering iron from the accessory bag, and insert #20 gasket into the ring and into the iron frame.
2. Put the front head straight into the car body
3. Fixed installation of front mud board
4. Mount the upper body to match it according to the left and right directions and fix it with cap nuts.



Installation of rear mud board

1. Insert mud board into both sides behind the vehicle body
2. Remove the motor from the controller and set aside for standby
3. Turn the car over and fix both sides with screws respectively.



Rear axle installation

1. Adjust the rear axle fixing parts in the vehicle body first
2. Use a screwdriver to push the spring down and back into the rear axle.
3. Install the removed electric motor into the rear axle (pay attention to distinguish left and right)



Rear wheel installation

1. Install the big wheel into the motor and fix it with washer screws. Repeat it for the other side.
2. Clip in hub



Front wheel installation

1. as shown in the figure, install the front wheel with gasket plus bushing and gasket.
2. Fix the front wheel with washer nut after installing the wheel.
3. Clip in hub



Steering wheel and exhaust pipe fixed

1. Remove the original steering wheel screw, insert the steering rod into the alignment hole, insert the falling rod and fix it with a screwdriver
2. The exhaust pipe can be directly inserted into the reserved seat as shown in the figure.



Operation method:

First, open the battery cover on the back of the remote control and install two 1.5vaaa alkaline batteries.

Note: the position of positive and negative poles shall prevent short circuit of power terminals.

1. Turn off the power of the car, press the key code for 3-5 seconds, the light flashes, the car power is turned on.
2. Forward/backward switch: press forward direction, vehicle forward form;
3. Turning left and right: control the rotation of the vehicle in the left and right directions.
4. Emergency stop button: control the vehicle in the case of emergency stop.
5. Fast and slow gears: adjust the speed of the vehicle in moving.
6. The remote-control button can be opened automatically and shut off automatically if idle for about two minutes.

Remarks: the remote control is for one-to-one use. The picture is for reference only

Charging

Note: This car is equipped with a charging protection function. All functions

of this car are not available when charging!

When charging, the power switch must be turned off.

Before the first use, it is recommended to charge for 4-6 hours, but not more than 10 hours.

When the normal running speed of the vehicle slows down obviously, it means that the battery power is insufficient, please charge it in time.

Please charge it for 8-12 hours after each use, but not more than 20 hours.

1. Insert the charger into the charging hole;
2. Plug the charger into the power socket;

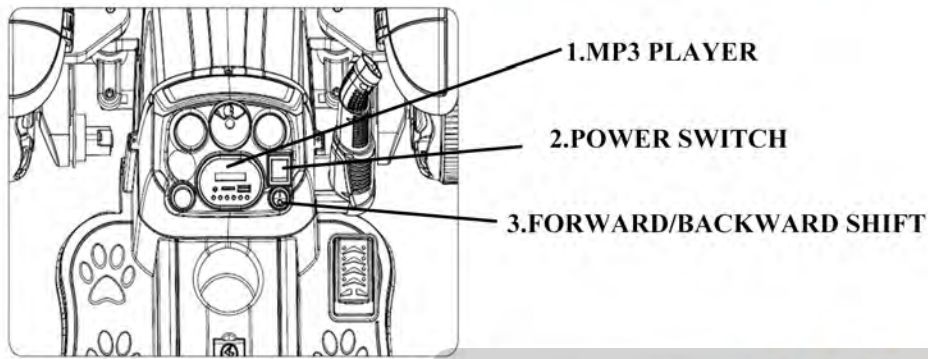

CHARGE HOLE



Warning:

* The vehicle assembly must be operated by an adult. It takes about 10 minutes to assemble the product.

Contains potentially dangerous sharp edges or sharp points before assembly.

* Tools needed for assembly: screwdriver (self-provided).

Warning: this electric buggy package contains small parts, choking danger, children are not allowed to touch and play!

Warning: please check the quantity of all parts before installation. Please handle the packaging of the product properly. Children are not allowed to play.

Warning: contains small parts, not suitable for children under 36 months of age!



Installation of alarm lights

1. Install the alarm lamp into the slot
2. Insert the corresponding plug-in

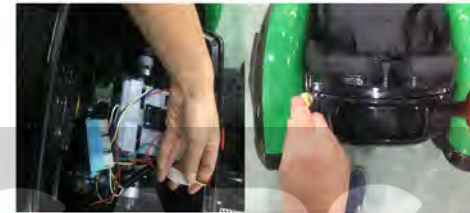

Power supply installation

1. Connect and plug the battery cable
2. Turn on the power and start to check whether the car starts normally.
3. Install the cushion and fix it with screws.



Optional: trailer installation

1. Fix the iron frame of the trailer pull rod with screws and nuts
2. wheel installation: install the wheel with gasket and fixed wheel sleeve, and then fix with gasket and nut.
3. Insert the bucket rod into the reserved seat of the car body, and install the car body with the fixing pin.
4. fix the seat with screws



Battery safety warning

Non rechargeable battery cannot be charged;

The rechargeable battery can only be charged under adult supervision;

The rechargeable battery should be taken out of the toy before charging point;

Different types of batteries or old and new batteries shall not be mixed;

The battery should be put in with correct polarity;

The exhausted battery should be removed from the toy;

The power terminal shall not be short circuited;

LEAN

CARS

WWW.LEANTOYS.PL

Safety warning

Please tell your child and his playmates the following safety rules and make sure they understand!

The vehicle must be driven under adult supervision.

When driving, you should wear a protective helmet, you must wear shoes and you must sit in the seat.

Make sure your child drives the vehicle in a safe driving environment, such as at home, in the garden or on the playground.

Note that vehicles are only suitable for driving on hard, flat roads. To ensure safety, it is prohibited to drive in the following unsafe environments:

- A. Pits, creeks, lawns, slopes or uneven ground;
- B. Places on public transport roads or other vehicles, pedestrians;
- C. Possible impact on obstacles that could cause injury;
- D. Other non-safety zones

Avoid children driving in the dark. Children will not deal with unexpected obstacles or accidents and should only drive during the day or in a bright area.

Do not use this product outdoors in rain or snow.

When changing gears, make sure that the vehicle has stopped moving completely.

Please confirm that the user of the modified product meets the age range of the product and cannot exceed the maximum load.

Do not change the structure and wiring system of the product.

Regularly check whether there is aging and falling off of the wire plug of the vehicle.

To avoid this, please make sure the vehicle is safe before driving.

Please do not let any children near a moving vehicle and do not let children touch the wheels.

The car is equipped with seat belts. Please instruct the children to fasten the seat belts to ensure safety.