

WARNING:

Do not mix alkaline standard(carbon-zinc),
or rechargeable(nickel-cadmium) batteries.

- Toys can't connected to more than the recommended number of power.
- Non rechargeable battery can not charge.
- Rechargeable batteries can only be used in adult guardianship.
- Charge the battery before charging the battery should be removed from the toy.
- Battery should be placed in the correct polarity.
- The exhausted battery should be removed from the toy.
- Power supply terminals shall not be short circuit.
- The toy shall only be used with a transformer for toys.
- The transformed is not a toy.
- The model number or specification of a suitable transformer for use with the toy.
- The toy is disconnected from the transformed before cleaning

Remark:

When the above marking are on the packaging only, it shall also be stated that the packaging must be retained since it contain important information.

H. Product qualification certificate

Qualification certificate	Production date:
	Checker:

- The diagrams in this manual are used to illustrate the operating method and the structure of this product, and there may be some difference between the practicality and the diagrams, and the practicality shall prevail.
- In order to improve the quality of the product, we may change some parts of the structure of the product or its appearance without notice in advance, which need your understanding.
- This manual contains important information and it must be well kept.

CHILDREN'S ELECTRIC VEHICLE: QUADRICYCLE

Before putting this product into use, please peruse this manual.

Please well keep it for reference in the future.

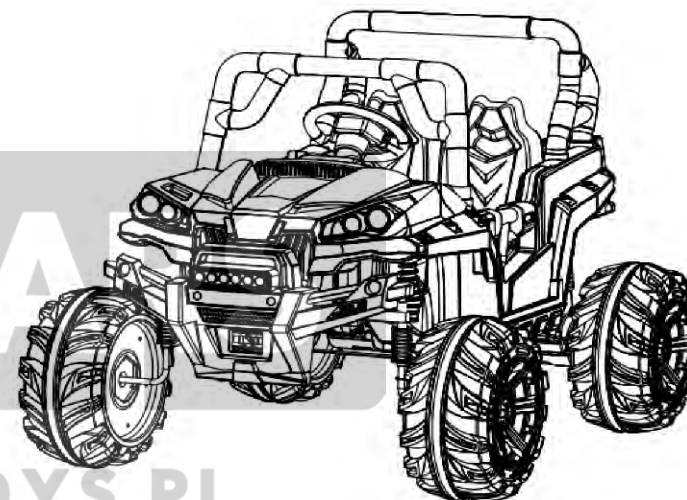

WARNING

- "Warning. Not to be used in traffic."
- The toy should be used with caution since skill is required to avoid falls or collisions causing injury to the user or third parties.
- Examples of safe riding areas.
- A recommendation for adult supervision of young children.
- Toys must be assembled by an adult.

This product is powered by lead-acid accumulator, so its electricity should never be used up. The accumulator should be charged in time whenever it lacks of electricity, or it may be damaged.

Before putting this product into use, please peruse this manual, which will tell you the correct operating method and assembling steps, so as to avoid your child being hurt or the vehicle being damaged by incorrect operation. Please well keep the manual in a place where you can get it easily when it is needed.

A Specifications

Suitable age	36-95 months	Load limit	30 kg
Accumulator	12V7AH	Size	130×93×91 cm
Charging time	10-14 hours	Speed	4.5 km/h
Gross weight	24 kg	Net wight	26 kg
Charger	Input: AC 220 V or 110V , Output: 1000 mA		

B Packing List

Serial number	Material name	Quantity	Notes
1	Body	1	
2	Windshield	1	
3	Armrest	1	
4	Seat	1	
5	Bumper	1	
6	Steering wheel	1	
7	Front wheel	2	
8	Rear wheel	2	The plum blossom
9	Wheel cover	4	
10	Brace	1	
11	Bogie	1	
12	Steering rod	1	
13	Rear axle	1	
14	Plastic wrench	2	
15	Charger	1	
16	Remote control	1	
17	MP3 line	1	
18	Instruction manual	1	
19	Screw bag	1	

G Circuit diagram

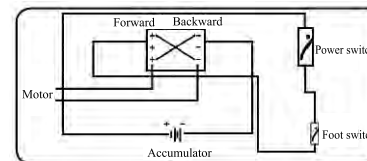

H Maintenance

- The main parts of the vehicle should be examined before being put into use. It should not be used when the accumulator, the charge, the wires, the plugs, the shell or other parts are damaged, or the screws are loosened, or there are any potential safety loopholes, until it has been repaired.
- Lubricate the iron parts of the vehicle with a little lubricant after the vehicle has been used for a period of time so as to avoid these parts being worn or rusted.
- The vehicle should be kept away from fire or long time sunshine. It should be placed flatwise and never let it be upside down or inclined; During the wet days, it should be parked covered with waterproof cloth or indoors.
- The vehicle should be kept away from hot objects, such as stoves and heaters, as the plastic parts may melt. While the vehicle is being charged, keep the vehicle away from combustibles so as to avoid fire.
- The vehicle should be charged in time when it is short of electricity, and it must be charged by adults. Before it is stored, the vehicle must be charged fully, and while it is kept in store it should be charged once every month, so as to prolong the accumulator's life-span.
- The vehicle can be cleaned with dry soft cloth. The plastic components can also be polished with non-wax polishing material so that their brightness can be improved, but chemical solvents should not be used in doing so. The vehicle can't be washed with soap and water, or be driven outdoors when it is raining or snowing, as water may damage the motor, the circuitry system and the accumulator.
- Turn off the power and push all the switches to "off" when the vehicle is not used or it will be stored.
- Don't use fuses that are not in accord with the specifications of this product.
- Don't change the structure or the circuitry system of this product, and it should be examined or fixed by professionals or under their instruction.

F Trouble shooting

Trouble type	How to check it	How to remove it
The motor doesn't work.	1. Is the overload protector blown? (Under the seat.)	If yes, the overload protector automatically cut off when the vehicle is overloaded or improperly operated; if no, see the next item.
	2. Is the foot switch well connected?	If no, repair the foot switch; If yes, see the next item.
	3. Are the wires welded well on the ends of the motor?	If no, weld the ends well; If yes, see the next item.
	4. Are the wire connectors well connected with the motor?	If no, connect the connectors well; If yes, see the next item.
	5. Will the motor work when it is connected directly with accumulator?	If no, change the motor with a new one; If yes, the driving circuitry board needs professional repair, thus, please contact our agent or the dealer.
The vehicle cannot move forward or it cannot move backward.	1. Check the forward/backward switch with a multi-meter and see if it is well connected.	If no, change the forward/backward switch with a new one; If yes, see the next item.
	2. Are the driving circuitry and the forward/backward switch well connected?	If no, connect the wires well; If yes, there is something wrong with the driving circuitry board, thus, please contact our agent or the dealer.
The vehicle moves slowly.	1. Is the voltage of the accumulator over 6V(one drive) or 12 V (two drives)?	If no, charge the accumulator; If yes, see the next item.
	2. Will the vehicle move faster when the motor (gear case) is connected directly with the accumulator?	If yes, there is something wrong with the driving circuitry board, thus, please contact our agent or the dealer. If no, see the next item.
The accumulator cannot be charged.	1. Are the connectors of the accumulator loosened or dropped?	If yes, connect the connectors well; If no, see the next item.
	2. Will the charger become a little warmer while it is being charged?	If no, the charger is damaged, thus, change it with a new one.
The vehicle can move but there is no sound or light.	1. Is the sound and light switch in good condition?	If no, change the switch with a new one; If yes, see the next item.
	2. Check the wires and connectors from the head of the vehicle to the accumulator and see if they are in good condition.	If no, connect the connectors and the wires well.
Wheels doesn't work	1. Can the driving wheel turn?	If yes, let the wheels touch the ground; If no, see the next item.
	2. Check the gear case and see if the gear wheels are damaged?	If yes, change the gear case with a new one.
The vehicle often stops while it is moving.	1. Is the vehicle overloaded (over 30 kg)?	If yes, nothing is wrong with the vehicle; If no, see the next item.
	2. Is the vehicle being driven on a bumpy surface?	If yes, nothing is wrong with the vehicle, as it should be driven on concrete road; if no, see the next.
	3. Can the non-driving wheel be turned freely?	If no, repair the wheels or the axles.

When customers don't have the conditions to apply the above mentioned trouble shooting methods, please contact our agent.

C DIAGRAM

Note: Some parts need to be installed on both sides.

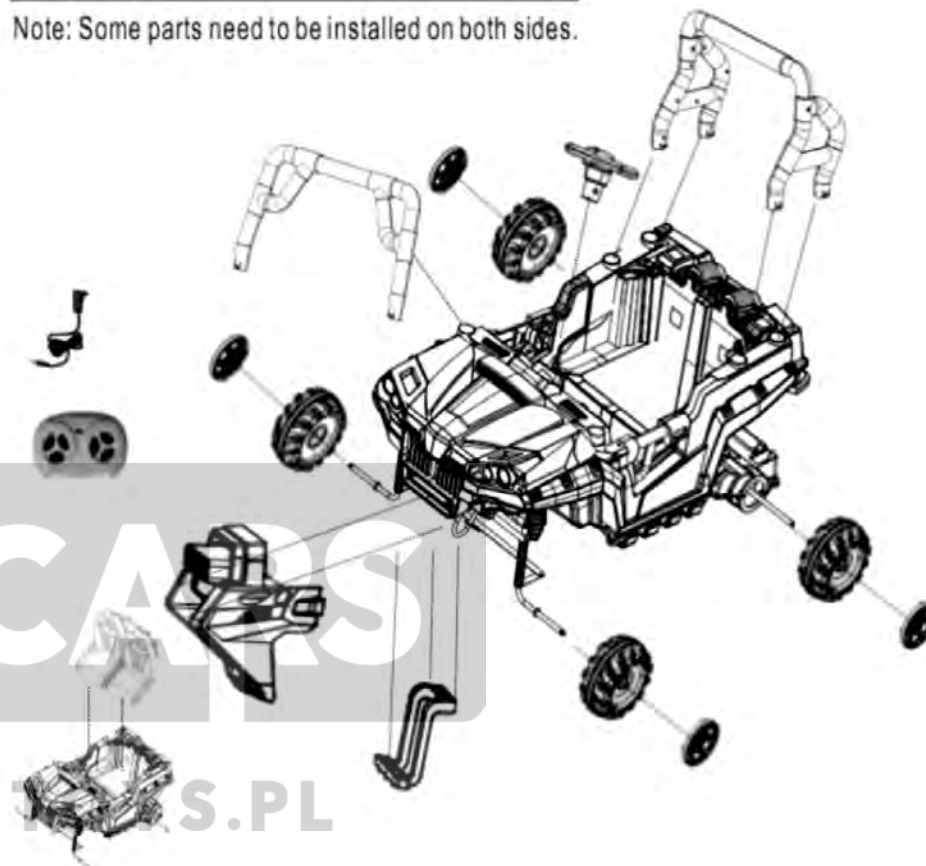

! warning

Please put the bag away in time to avoid asphyxiation caused by play
 Products must be assembled by adults
 Please bring your own installation tools, pointy insert and screwdriver
 Contains small parts for use by children aged 3 and under

C Assembling steps

The vehicle must be assembled by adults, which needs about 10 minutes. Following tools are needed: a screwdriver (prepared by yourself). Don't let children touch or play the small components so as to avoid children being choked. Please check the quantity of the components before assembling. Deal with the plastic bags properly and don't let children play the bags so as to avoid them being choked.

1. Install the bumper and support frame and bogie.

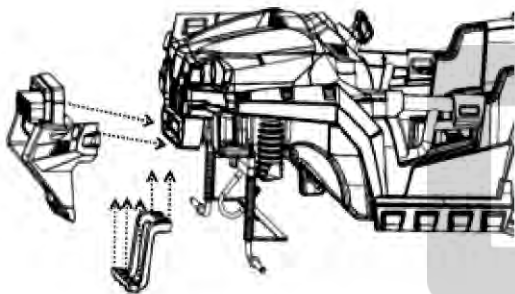

1. Turn the bottom of the car body up.
2. Fix the bumper with 2 pcs $\text{Ø}4 \times 14\text{mm}$ screws.
3. Place the support bracket on the front end of the car body, and fix it with 5 pieces $\text{Ø}4 \times 14\text{mm}$ screws;
4. Put the bogie on the front end of the round hole, and tighten it with 2pcs $\text{Ø}8$ gaskets and M8 nuts (Note: the bogie cannot be installed in reverse)



Music button

Foot switch

Forward /
reverse
switching

- ① Music switch: Push the button on the steering wheel, and you can hear horn sound or music.
- ② Power switch: Turn on / turn off the power.
- ③ Forward/Backward switch: Control the vehicle's moving direction—forward or backward, together with the use of the foot switch.
- ④ Charging hole: See the charging method mentioned above in D.
- ⑤ Foot switch: Control the vehicle's moving direction— forward or backward, together with the use of the forward/backward switch.
- ⑥ Remote/Manual switch: Push the switch at “Manual” and then operate the foot switch; push the switch at “Remote” and then operate the remote control.
- ⑦ Volume adjustment (optional): Control the music volume with it.
- ⑧ 3.5 mm audio frequency interface (optional): 3.5mm audio frequency put-in interface.

WWW.LEANTOYS.PL

Optional features



- 1, first remove the battery cover on the remote control, in the section 2 batteries in the right way.
- 2, for the first time to use the code, this product has the memory function, after replacing the battery without having to code.
- 3, the code steps:
Long press to code for 3 to 5 seconds, until the LED lights flashing, open the power supply buggies, LED lights into long, the code is successful, See note on the back of the remote control to use.

Warning:

The remote control is not a toy, should be used by adults, children can not touch play.

Disclaimer:

The remote control pattern is for reference only, please refer to the object.

E Usage method

Safety cautions

Please tell the following safety rules to your children and their playmates, and make sure that they understand them.

- This vehicle must be used under the supervision of adults.
- Keep the small components away from children below 3 years old so as to avoid them being hurt.
- Keep the packing bags and other plastic material away from children so as to avoid the risk of them being choked.
- The driver must wear shoes while he/she is driving.
- The driver must sit on the seat while he/she is driving.
- The vehicle must be driven in a safe environment, such as home, garden or playground.
- This vehicle can only be driven on flat hard surfaces. Don't drive the vehicle in the following unsafe environment:
 - A. In ditches or pits, near small rivers, on lawns, slopes or accidented surfaces.
 - B. On high ways or in places where other kinds of vehicles run or pedestrians walk.
 - C. Places contains obstacles which may hurt children when the vehicle hit it.
 - D. Other unsafe places.
- The vehicle should be driven only in daytime and must not be driven in the dark as children don't know how to deal with the unexpected obstacles or accidents.
- Don't drive the vehicle outdoors when it is raining or snowing.
- Make sure that the vehicle is stopped completely before the gear being shifted.
- Make sure that the driver is suitable to use the vehicle concerning the age and don't overload it.
- Don't change the structure or the electrocircuit of this vehicle.
- Check the wire connectors regularly to see if they are in good condition.
- Make sure that the vehicle is in good condition so as to avoid accidents.
- Don't let children touch the wheels or get close to the moving vehicle.

Please teach children how to use the safety belt installed with the vehicle so as to ensure children's safety.

2. Install steering rod and rear support.



1. Turn the bottom of the body up.
2. Put the steering rod from bottom to top, and then fix it with $\varnothing 5 \times 25$ mm screw and M5 nut
3. Install supporting parts.

(as shown in the picture) open the large frame, install the supporting parts on the large frame with 2pc $\varnothing 5 \times 55$ mm screws and 2pc M5 nuts, and place the supporting parts on the body;

3. Install front wheel and rear wheel.

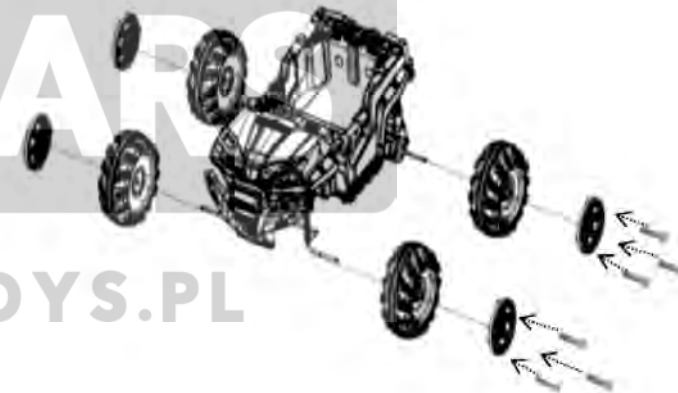

1. Install the front wheels: first on the front axle through a $\varnothing 12$ gaskets, install the front wheels, and through a $\varnothing 10$ gaskets, with M8 tighten nut
2. Install the wheel cover and fix the wheel cover with 3 pcs of $\varnothing 4 \times 14$ mm screws (Note: the front wheel installation method is the same)
3. Install the rear wheel: rear axle to wear on the body, put a rear wheel, through a $\varnothing 10$ gaskets, reoccupy M8 nut and tighten
4. Install the wheel cover and fix the wheel cover with 3pcs 4×14 mm screws (Note: the rear wheel installation method is the same)

4. Install steering wheel and seat.



1. **Install the steering wheel:** connect the wire terminal before installation, and fix it with $\varnothing 5 \times 40$ mm and M5 nuts. (Note: the steering wheel can not be mounted back and back.)

2. **Install the seat:** place the seat card on the car body, and fix it with 2 pcs of $\varnothing 4 \times 12$ mm screws and 3 pcs $\varnothing 4 \times 14$ mm screws.

5. Install the windshield and backrest.



1. **Install the windshield:** place the windshield on the body.

2. **Install backrest:** place the back card on the body.

The whole assembly is completed, check whether leakage, product function is normal.

D Charging

Note: This vehicle has a function of charging protection, and while it is being charged, other functions can't be used at all.

- The power switch must be turned off while the vehicle is being charged.
- Before it was first put in use, the vehicle is supposed to be charged for 4-6 hours, never over 10 hours.
- Please charge the vehicle when it runs much more slowly, which indicates that the accumulator lacks of electricity.
- Please charge the vehicle for 8-12 hours each time after it has been used, but don't charge it over 20 hours.

1. Insert the plug of the charger into the charging hole.
2. Insert the other plugs of the charger into the socket of power supply.
3. This product is powered by lead-acid accumulator, so its electricity should never be used up. The accumulator should be charged in time otherwise it may be seriously damaged.



4. Battery charge with toys need regular checker wire plug shell and other components are damaged should stop using found damaged complete until the repair.

1. Insert the plug of the charger into the charging hole.
2. Insert the other plugs of the charger into the socket of power supply.
3. Never insert any metal articles into the charging hole so as to avoid the vehicle being short-circuited and damaged.